

## ES-BOX12 Series

5.12/10.24/14.34/16.08kWh

### Home Energy Storage Battery

ES-BOX12 Series battery features 5.12/10.24/14.34/16.08kWh high-capacity design with doubled energy density. Premium LiFePO4 cells ensure safety and longevity, ideal for residential and commercial applications.



WiFi/Bluetooth remote monitoring (optional)



1C/1C continuous charge and discharge



Max. 64 modules parallel



Compatible with multiple inverter brands



Superior LiFePO4 safety performance



10 years standard warranty

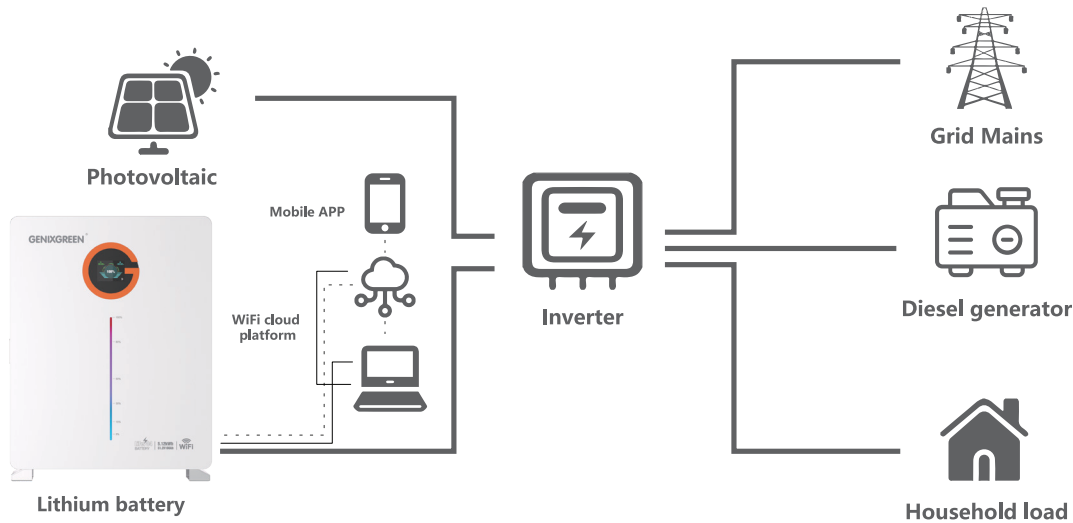

## Product Specification

Product Model	ES-BOX12	ES-BOX12 PLUS	ES-BOX12 MAX	ES-BOX12 MAX+
Nominal Energy	5.12kWh	10.24kWh	14.34kWh	16.08kWh
Nominal Voltage	51.2V			
Nominal Capacity	100Ah	200Ah	280Ah	314Ah
Cell Type	LFP			
Standard Charge Voltage	56.8V			
Max.Charge/Discharge Current	100A	150A	200A	200A
Discharge Cut-Off Voltage	44.8V			
Parallel Function	Parallels: Max.16, Max.33, Max.64 (Optional)			
Communication Interface	USB/RS485/CAN			
Cycle Life	>8000 Cycles(25°C±2°C, 0.5C, 90%DOD@65%EOL)		≥10000 Cycles (25°C±2°C, 0.35C, 90%DOD@65%EOL)	
Charge Temperature Range	0~55°C			
Discharge Temperature Range	-20~55°C			
Certification	Pack: CEI 0-21/CE/IEC 62619/UL1973 by Intertek/MSDS/UN38.3 Cell:: UL1642/IEC 62619/CE/EMC/ROHS/MSDS/UN38.3			
Dimension	480*600*155mm (Excluding Wall-Mounted Brackets)	480*650*250mm (Excluding Wall-Mounted Brackets)	490*840*247mm (Excluding Wheels)	490*840*247mm (Excluding Wheels)
Net Weight	51Kg	90Kg	122Kg	122Kg
Installation Method	Wall-Mounted/Floor Standing			
Warranty	10 years warranty, 15 years design life			
Energy Throughput <sup>[1]</sup>	22MWh	44MWh	62MWh	70MWh
Display	RGB LED Light/3.2" LCD Touch Screen		RGB LED Light/4.3" LCD Touch Screen	
Optional	Circuit Breaker,WiFi Remote Monitoring			

[1] Conditions apply, refer to GENIXGREEN warranty letter.